

SKETCH/AREA TABLE ADDENDUM

SUBJECT INFO

File No.: 607200 Parcel No.: 062W32CA02700
 Property Address: 5651 49TH AVE NE
 City: Salem County: MARION State: OR ZipCode: 97305
 Owner:
 Client: Client Address:
 Appraiser Name: Inspection Date:

SKETCH

607200
062W32CA02700

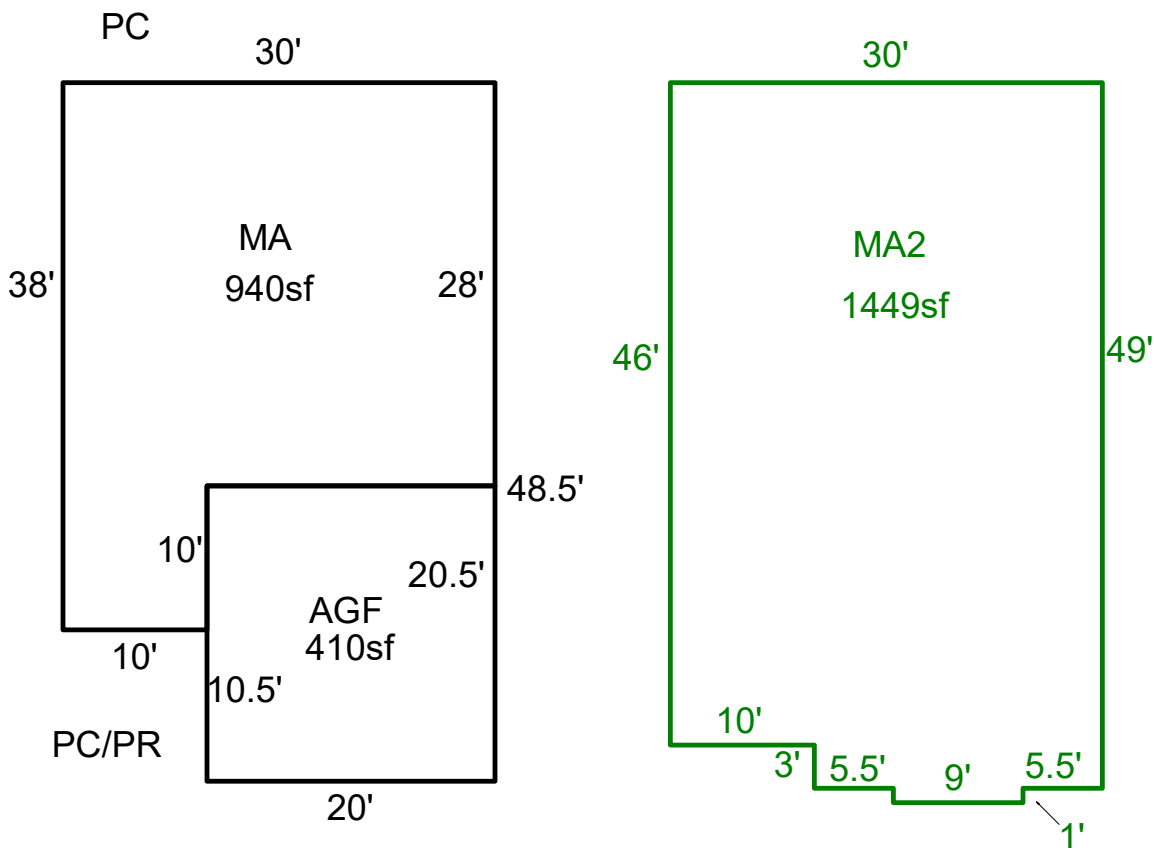

Sketch by ApexSketch

AREA CALCULATIONS SUMMARY

Code	Description	Factor	Net Size	Perimeter	Net Totals
GLA	MA	1.0	940.0	136.0	940.0
GLA2	MA2	1.0	1449.0	160.0	1449.0
GAR	AGF	1.0	410.0	81.0	410.0

COMMENT TABLE 1

APEX BY CLOBERG 06/26/2024
 Updated by AEIwood 8.9.24

COMMENT TABLE 2

COMMENT TABLE 3

Net LIVABLE cnt 2 (rounded) 2,389