

SKETCH/AREA TABLE ADDENDUM

SUBJECT INFO

File No.: 607199 Parcel No.: 062W32CA02600
 Property Address: 5665 49TH AVE NE
 City: SALEM County: Marion State: OR ZipCode: 97305
 Owner:
 Client: Client Address:
 Appraiser Name: Inspection Date:

SKETCH

607199
062W32CA02600

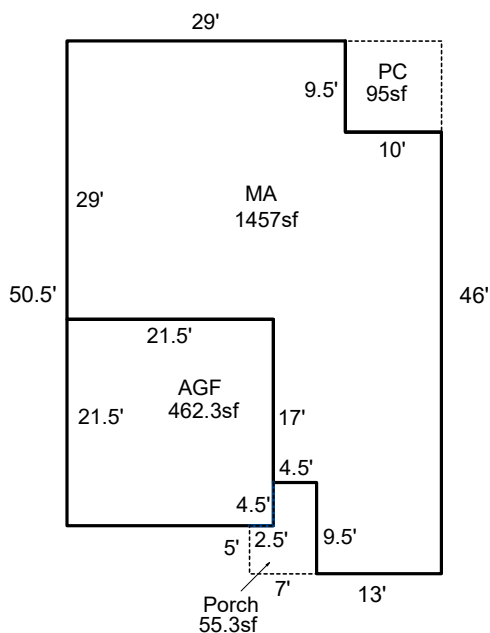

Sketch by ApexSketch

AREA CALCULATIONS SUMMARY						COMMENT TABLE 1		
Code	Description	Factor	Net Size	Perimeter	Net Totals			
GLA1	MA	1.0	1457.0	189.0	1457.0	APEX BY CLOBERG 06/26/2024		
GAR	AGF	1.0	462.3	86.0	462.3			
P/P	PC	1.0	95.0	39.0	95.0			
	Porch	1.0	55.3	33.0	150.3			
						COMMENT TABLE 2	COMMENT TABLE 3	
Net LIVABLE						cnt	1 (rounded)	1,457