

Acct ID: 560451 MTL: 093W24D000400 Date: 5/20/24 Appr: MDL Prop Class: 401 RMV Prop Class: 401  
 Situs: 12512 CENTERWOOD RD SE JEFFERSON OR 97352 MaSaNh: 07 06 003 Unit: 102709 Year: 2024

Last Date Appraised: 04/04/2019 Appraiser: MATT LORD Retag: Y N Tag info:

Owner: POCESKI, MARIO Roll Type: R

Cycle Tag Sales Verification Other: \_\_\_\_\_ Inspection level: 1 2 3 4 LCB TTO INSP AV: 343050

RMV Land: 256390 RMV Imp: 384950 RMV Total: 641340 MAV: 343050 MSAV: 0 SAV: 0

Comment: MLS 8/1087 sold: \$ 755,000 (30)  
Down 144

**Notations**

No notation data available.

**OSDs**

Count	Code	Description	RMV	Code Area	Exception
1	MKTA	OSD - AVERAGE	45000	14530	0

**Land**

Site: 1 Code Area: 14530 Size: 2.15 Acres Use Code: 004 Zone: NREST SAV Use: Exception: 0  
 Class: Value Source: Rural at MKT Description: RMV: 211390 Exception: Y N  
 Adjustment(s): VWAR Fire Patrol: Description:  
 Comments: 08-09: 44 CYCLE WORK, CORRECTED VIEW ADJ // 03-04: REAPPRAISAL 04-05: RECALC PROJECT, LAND SCHEDULE CHANGES.

**Improvements - Residence / Manufactured Structures**

Bldg: 1 Code Area: 14530 Stat Class: 143 Year Blt: 1983 Eff Year Blt: 1998 Sq.Ft: 2450 % Complete: 100  
 Desc: One Story with basement Dimensions: RMV: 384950  
 Func Obsc: 100 Econ %: 100 Other %: 100 Exception: 0 Adjust: Adjust RMV: 0

**Floors**

Type	Class	Display Group	Floor Size	Beds	Baths	Yr Blt	Eff Yr Blt	Inventory	Exception: Y N
First Floor	4	Finished	1568	3	FB-2	1983	1998	KIT-, HVAC+, BATH - 2, ROOF	Exception: Y N
Basement	4	Finished	882	1	FB-1/ HB-1	1983	1998	HVAC+, BTH - 1	Exception: Y N
Garage Basement	4	Finished	686	0	0	1983	1998		Exception: Y N

**Accessories**

Description	Class	Size SqFt	Eff Yr Blt	RMV	Quantity	Exception: Y N
ASPHALT DRIVEWAY	4	1900	2009	5301	1	Exception: Y N
CONCRETE DRIVEWAY	4	480	1983	1248	1	Exception: Y N
DECK	4	1266	1998	22282	1	Exception: Y N

**Improvements - Accessory Buildings**

No improvement data available for all other stat class types.

MP 4      MP \$      LTL      LTL      LTL  
9x17      6x8      4x6      9x8      4x8  
AV6      AV6

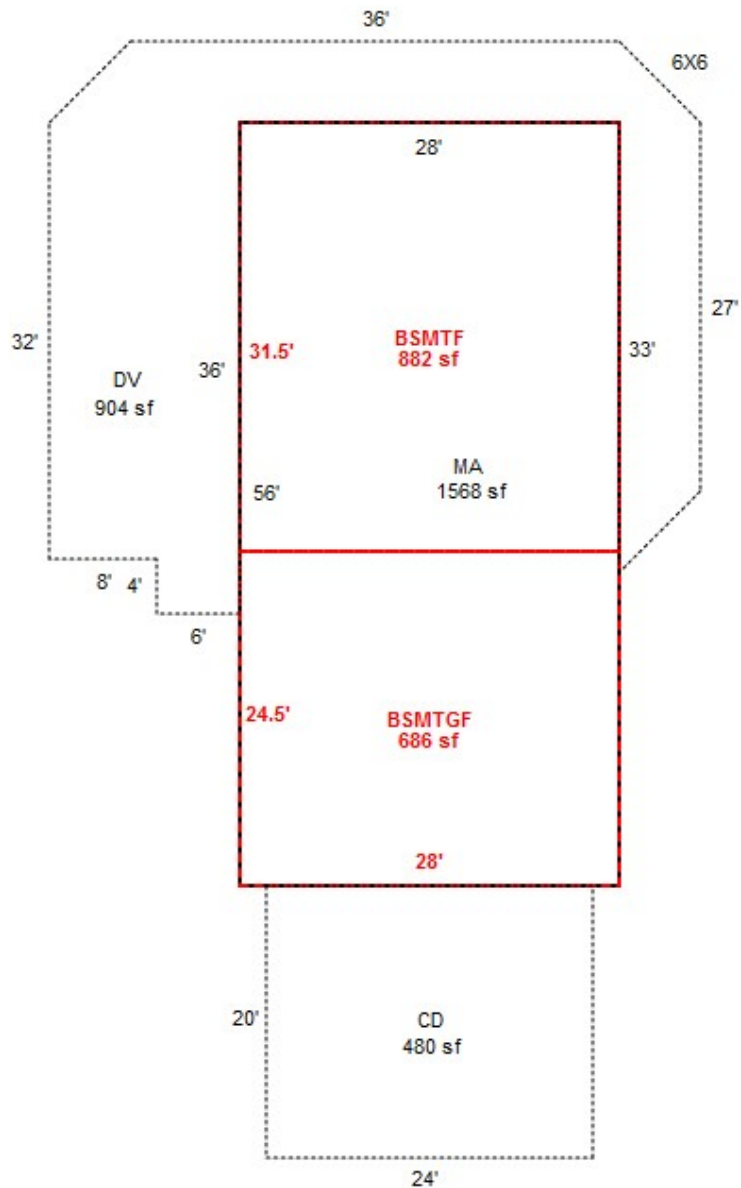
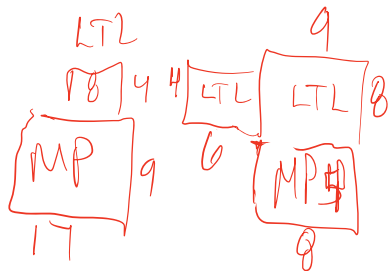

MDL 5/20/24  
LH SV

