

Acct ID: 559771 MTL: 093E25DD01300 Date: **2-7-24** Appr: **luke** Prop Class: 401 RMV Prop Class: 401
 Situs: 33742 RAILROAD AVE SE GATES OR 97346 MaSaNh: 01 06 000 Unit: 136536 Year: 2024

**INPUT
2-7-24
luke**

Last Date Appraised: 11/19/2021 Appraiser: CLINT LUKE Retag: Y **N** Tag info:
 Owner: PETERSON, KRISTOPHER J & Roll Type: R
 Cycle Tag Sales Verification Other: Inspection level: 1 2 3 **4** LCB TTO INSP AV: 618980
 RMV Land: 283810 RMV Imp: 642000 RMV Total: 925810 MAV: 618980 MSAV: 0 SAV: 0
 Comment: L2 11.19.21 CL
 LEVEL 4 11.20.20 WV06//

**JUST CYCLED THROUGH TAGS
 UPDATE OSD NO OTHER CHANGES**

Notations

No notation data available.

OSDs

Count	Code	Description	RMV	Code Area	Exception
1	MKTN	OSD - NO LANDSCAPE A	30000	56490	0

Land

Site: 1 Code Area: 56490 Size: 1.69 Acres Use Code: 004 Zone: NREST SAV Use: Exception: 0
 Class: Value Source: Rural at MKT Description: RMV: 253810 Exception: Y N
 Adjustment(s): H2OGR Fire Patrol: SA004 Description: FIRE PATROL
 Comments: 21-22: PER #06 DEL ALL IMPS, OSD// 2010-2011 CYCLE WORK #36 CHANGED OSD'S//

Improvements - Residence / Manufactured Structures

Bldg: 1 Code Area: 56490 Stat Class: 151 Year Blt: 2021 Eff Year Blt: 2021 Sq.Ft: 3420 % Complete: 100
 Desc: One Story Only Dimensions: RMV: 642000
 Func Obsc: 100 Econ %: 100 Other %: 100 Exception: 0 Adjust: Adjust RMV: 0

Floors

Type	Class	Display Group	Floor Size	Beds	Baths	Yr Blt	Eff Yr Blt	Inventory	Exception: Y N
First Floor	5	Finished	3420	5	FB-4	2021	2021	BATH+, HVAC, ROOF, KIT, BATH - 4	Exception: Y N
Garage Attached	5	Finished	812	0	0	2021	2021	ROOF	Exception: Y N

Accessories

Description	Class	Size SqFt	Eff Yr Blt	RMV	Quantity	Exception: Y N
PATIO	5	210	2021	1143	0	Exception: Y N
PATIO	5	312	2021	1699	0	Exception: Y N
PATIO	5	1168	2021	6360	0	Exception: Y N
ROOF EXTENSION OR PATIO COVER	5	210	2021	6029	0	Exception: Y N
ROOF EXTENSION OR PATIO COVER	5	432	2021	12403	0	Exception: Y N

Improvements - Accessory Buildings

No improvement data available for all other stat class types.

SKETCH/AREA TABLE ADDENDUM

SUBJECT INFO

File No.: R59771 Parcel No.: 093E25DD01300
 Property Address: 33742 Railroad Ave SE
 City: Gates County: State: OR ZipCode: 97346
 Owner:
 Client: Client Address:
 Appraiser Name: Inspection Date:

SKETCH

R59771
093E25DD01300
 SCALE = 1:20

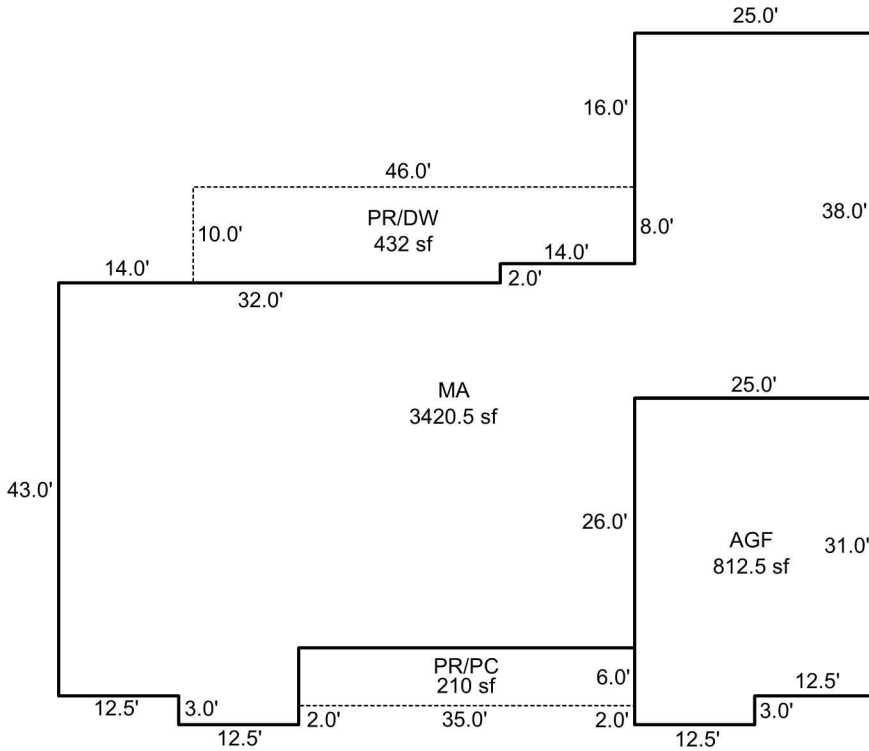

CD

Sketch by Apex Sketch

AREA CALCULATIONS SUMMARY

Code	Description	Factor	Net Size	Perimeter	Net Totals
GLA1	MA	1.0	3420.5	314.0	3420.5
GAR	AGF	1.0	812.5	118.0	812.5
P/P	PR/PC	1.0	210.0	82.0	
	PR/DW	1.0	432.0	112.0	642.0

COMMENT TABLE 1

Apex 9/26/2012 Jane
 UPDATED BY CJURAN 01/19/2021 555-20-007975

COMMENT TABLE 2

WV #06 11/20/2020 AOG
 01/19/2021 555-20-00797

COMMENT TABLE 3

Net LIVABLE cnt 1 (rounded) 3,421