

Summary Lead Appr: WW Clerk: _____ Lead Clerk: _____ Appr: MDL Print Date:

12/14/2023

Acct ID: 123951 MTL: 092W01B000100P1 Date: 2/7/24 Appr: MDL Prop Class: 049 RMV Prop Class: 049

535034

Situs: 8983 WEST STAYTON RD SE AUMSVILLE, OR 97325 MaSaNh: 07 06 000 Unit: 139906 Year: 2024

Last Date Appraised: 10/14/2016 Appraiser: MATT LORD Retag: Y N Tag info: 2024 - Tags/Permit (Demolished)

Owner: HODGES, EDNA B & COOK, DONNA M Roll Type: MS

Cycle Tag Sales Verification Other: _____ Inspection level: 1 2 3 4 LCB TTO INSP AV: 8290

RMV Land: 0 RMV Imp: 16690 RMV Total: 16690 MAV: 8290 MSAV: 0 SAV: 0

Comment: MFD STRUCT SERIAL # OW2354, X # X00066178, Home ID 153950 ON REAL ACCT 092W01B 00100, PERSONAL MS

Notations Demol 2019

RP/MS	Code	Description
MS	ZONED	FARM EFU ZONED

[mwiltse added note 3/4/24 ww](#)

OSDs

No OSD data available.

Land

No land data available.

Improvements - Residence / Manufactured Structures

Bldg: 1 Code Area: 05555 Stat Class: 444 Year Blt: 1972 Eff Year Blt: 1972 Sq.Ft: 672 % Complete: 100
 Desc: MANUF STRUCT, CLASS 4, 14' WIDE SINGLE Dimensions: 48x14 RMV: 16690
 Func Obsc: 100 Econ %: 100 Other %: 100 Demol Exception: 0 Adjust: Adjust RMV: 0

Floors

Type	Class	Display Group	Floor Size	Beds	Baths	Yr Blt	Eff Yr Blt	Inventory	Exception: Y N
First Floor	4	Finished	672	2	FB-1	1972	1972	SKIRT, ROOF+, HVAC+, KIT-, BATH - 1	Y N

Accessories

Description	Class	Size SqFt	Eff Yr Blt	RMV	Quantity	Exception: Y N
DECK	4	152	1972	669	0	Y N
ROOF EXTENSION OR PATIO COVER	4	400	1972	2320	0	Y N

Improvements - Accessory Buildings

No improvement data available for all other stat class types.

R35034
092W01B 00100
SCALE=1:50
N

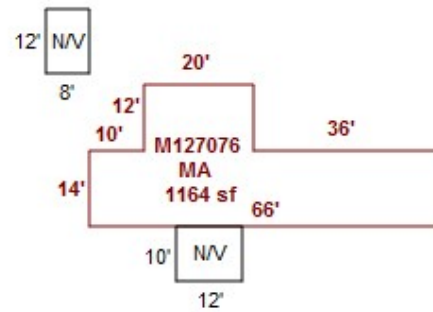
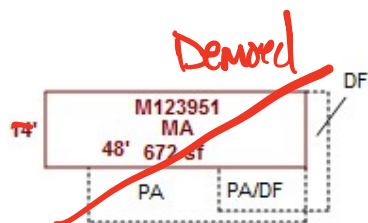
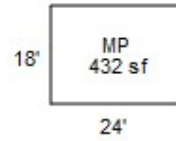
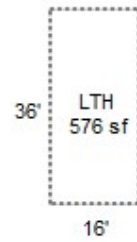
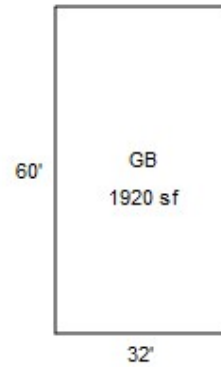

BUILDING DIAGRAM AND OUTBUILDINGS

ACCT. NO.

61385-000

MAP NO.

1-9-2W

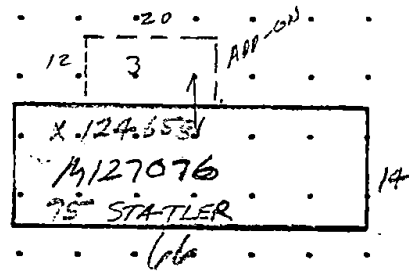
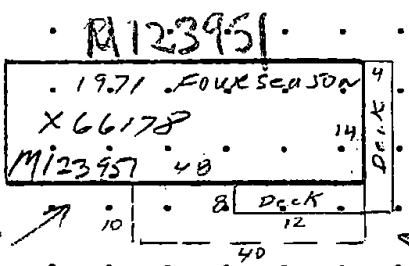
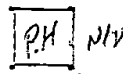
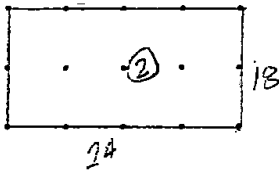
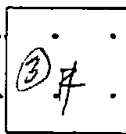
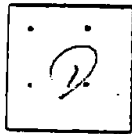
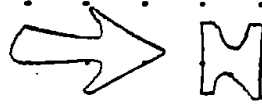

These imp. valued with M+.

8983 W STAYFON RD SE

MEASUREMENT VERIFIED		REMARKS:
DATE	BY	
4-14-87	REYES	Both M+ sharing Some Septic + well M14 X 66178 move in 1986
1-7-92	KEN #32 VER	
10/14/16	#36	

