

Summary Lead Appr: WW Clerk: _____ Lead Clerk: _____ Appr: MDL Print Date: _____

7/31/2023

Acct ID: 356396 MTL: 082W23C001202 Date: 11/2/23 Appr: MDL Prop Class: 401 RMV Prop Class: 401
 Situs: 7552 BARTOL WAY SE SALEM OR 97317 MaSaNh: 07 06 000 Unit: 59088 Year: 2023
2024
 Last Date Appraised: 01/03/2023 Appraiser: MATT LORD Retag: Y N Tag info: 2024 - Tags/Permit (Alt Energy System)
 Owner: KOSTROMITIN, EUGENE Roll Type: R
 Cycle Tag Sales Verification Other: _____ Inspection level: 1 2 3 4 LCB TTO INSP AV: 1748940
 RMV Land: 197050 RMV Imp: 2163320 RMV Total: 2360370 MAV: 754800 MSAV: 0 SAV: 0
 Comment: 23-24: L2 1.3.23 MDL
 22-23: L2 12.07.21 CL

INPUT MDL 12/8/23 WW

Notations 24-25: ADD solar / No change Db
 No notation data available.

OSDs

Count	Code	Description	RMV	Code Area	Exception
1	MKTG	OSD - GOOD	55000	05558	0

Land

Site: 1	Code Area: 05558	Size: 1.26 Acres	Use Code: 004	Zone: NREST	SAV Use:	Exception: 0
Class: 6H	Value Source: Rural at MKT	Description: SIX HILL			RMV: 87780	Exception: Y N
Adjustment(s): FSOIL		Fire Patrol:		Description:		
Comments: 19-20: DISQ FARM USE						
Site: 2	Code Area: 05558	Size: 0.74 Acres	Use Code: 004	Zone: NREST	SAV Use:	Exception: 0
Class: 4HD	Value Source: Rural at MKT	Description: FOUR HILL DRY			RMV: 54270	Exception: Y N
Adjustment(s): FSOIL		Fire Patrol:		Description:		
Comments: 19-20: DISQ FARM USE						

Improvements - Residence / Manufactured Structures

Bldg: 1	Code Area: 05558	Stat Class: 164	Year Blt: 2021	Eff Year Blt: 2021	Sq.Ft: 8981	% Complete: 100
Desc: Multi Story above grade with basement					Dimensions:	RMV: 1807520
Func Obsc: 100	Econ %: 100	Other %: 100	Exception: 994140	Adjust:	Adjust RMV: 0	

Floors

Type	Class	Display Group	Floor Size	Beds	Baths	Yr Blt	Eff Yr Blt	Inventory	Exception
First Floor	6	Finished	3830	2	FB-2/ HB-2	2021	2021	KIT-, BTH - 2, BATH - 3, BATH+, FP, ROOF, HVAC+	Exception: Y N
Second Floor	6	Finished	2889	2	FB-1	2021	2021	BATH - 1	Exception: Y N
Basement	6	Low Cost	2262	0	0	2021	2021		Exception: Y N
Garage Attached	6	Finished	1618	0	0	2021	2021	ROOF	Exception: Y N

Accessories

Description	Class	Size SqFt	Eff Yr Blt	RMV	Quantity	Exception
ENCLOSED PORCH	6	971	2021	84515	0	Exception: Y N
MISCELLANEOUS	6	42	2021	10300	1	Exception: Y N
OUTDOOR AMENITIES FP / KITCHEN	6	0	2021	7000	1	Exception: Y N
OUTDOOR AMENITIES FP / KITCHEN	6	0	2021	11700	1	Exception: Y N
SAUNA	6	35	2021	4731	0	Exception: Y N
SWIMMING POOL	6	240	2021	20640	0	Exception: Y N
YARD IMPROVEMENTS EXCELLENT	6	0	2021	57600	1	Exception: Y N

Bldg: 2	Code Area: 05558	Stat Class: 158	Year Blt: 2021	Eff Year Blt: 2021	Sq.Ft: 1216	% Complete: <u>50</u>
Desc: Res other improvements					Dimensions:	RMV: 355800
Func Obsc: 100	Econ %: 100	Other %: 100	Exception: 0	Adjust:	Adjust RMV: 0	

Floors

Type	Class	Display Group	Floor Size	Beds	Baths	Yr Blt	Eff Yr Blt	Inventory	Exception
Second Floor	5	Finished	1216	0	FB-1	2021	2021	BATH - 1	Exception: Y N
Garage Oversized Detached	5	Finished	2848	0	0	2021	2021	ROOF	Exception: Y N

Accessories

Description	Class	Size SqFt	Eff Yr Blt	RMV	Quantity
No accessory data available					

Improvements - Accessory Buildings

No improvement data available for all other stat class types.

ADD solar \$97,177

SKETCH/AREA TABLE ADDENDUM

SUBJECT INFO

File No.: 356396 Parcel No.: 082W23C 01202
 Property Address: 7552 BARTOL WAY SE
 City: SALEM County: State: OR ZipCode: 97317
 Owner:
 Client: Client Address:
 Appraiser Name: Inspection Date:

SKETCH

356396
082W23C 01202
SCALE=1:30



SEE PAGE 2 FOR
RES. DIMENSIONS

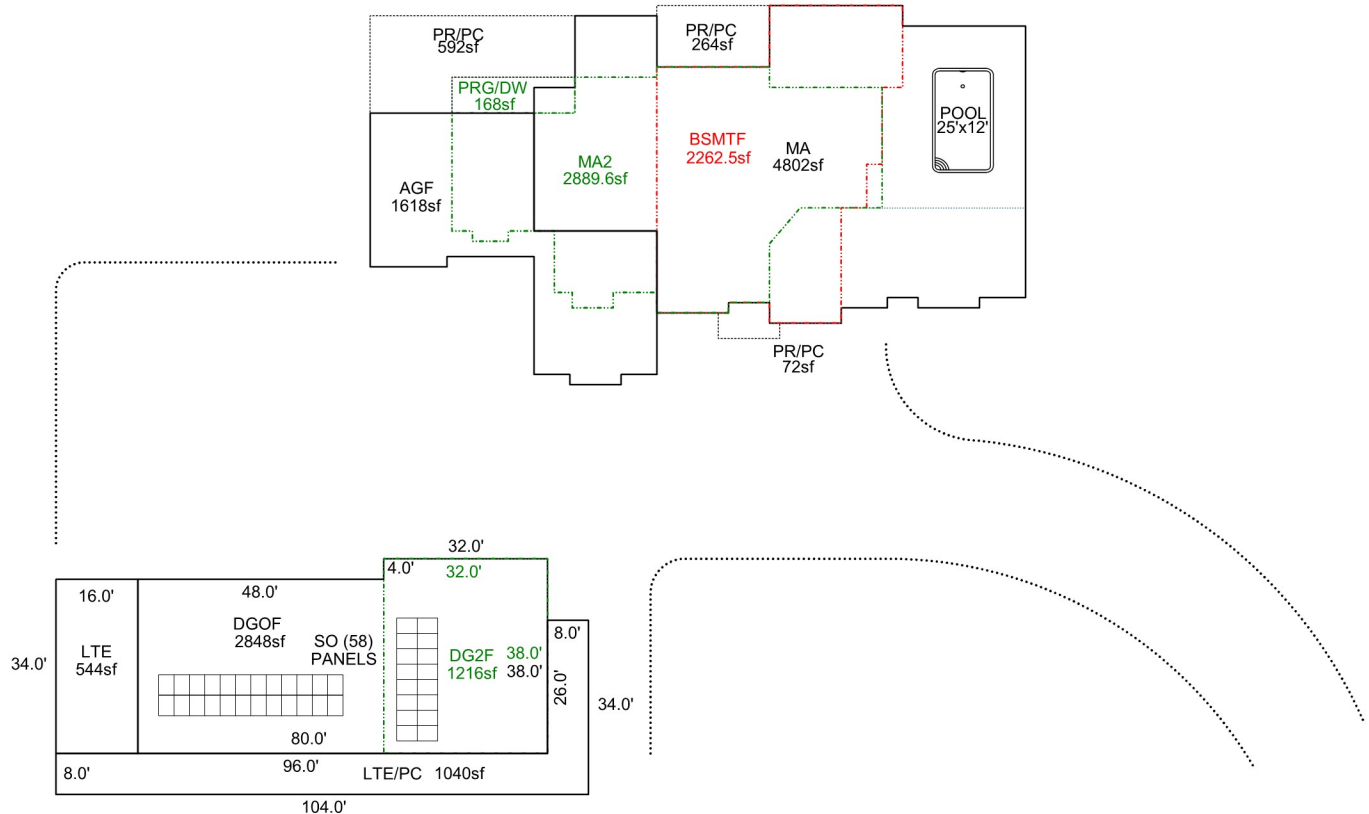

Sketch by Apex Sketch

AREA CALCULATIONS SUMMARY

Code	Description	Factor	Net Size	Perimeter	Net Totals
GBA1	DGOF	1.0	2848.0	236.0	
	LTE	1.0	544.0	100.0	
	LTE/PC	1.0	1040.0	276.0	4432.0
GBA2	DG2F	1.0	1216.0	140.0	1216.0
GLA1	MA	1.0	4802.0	344.0	4802.0
GLA2	MA2	1.0	2889.6	270.3	2889.6
BSMT	BSMTF	1.0	2262.5	224.0	2262.5
GAR	AGF	1.0	1618.0	222.0	1618.0
P/P	PRG/DW	1.0	168.0	62.0	
	PR/PC	1.0	72.0	38.0	
	PR/PC	1.0	264.0	68.0	
	PR/PC	1.0	592.0	118.0	1096.0
	Net LIVABLE	cnt	2 (rounded)		7,692
	Net BUILDING	cnt	4 (rounded)		5,648

COMMENT TABLE 1

APEX BY CJURAN 05/25/2021 555-21-001992
 & 555-21-002162
 UPDATED BY CJURAN 06/28/2021 555-21-003500
 UPDATED BY CJURAN 01/24/2022
 UPDATED BY CJURAN 01/11/2023 555-22-010959

COMMENT TABLE 2

COMMENT TABLE 3

TABLE 2 MAZ 11/2/23

SKETCH/AREA TABLE ADDENDUM

SUBJECT INFO

File No.: 356396 Parcel No.: 082W23C 01202
 Property Address: 7552 BARTOL WAY SE
 City: SALEM County: State: OR ZipCode: 97317
 Owner:
 Client: Client Address:
 Appraiser Name: Inspection Date:

SKETCH

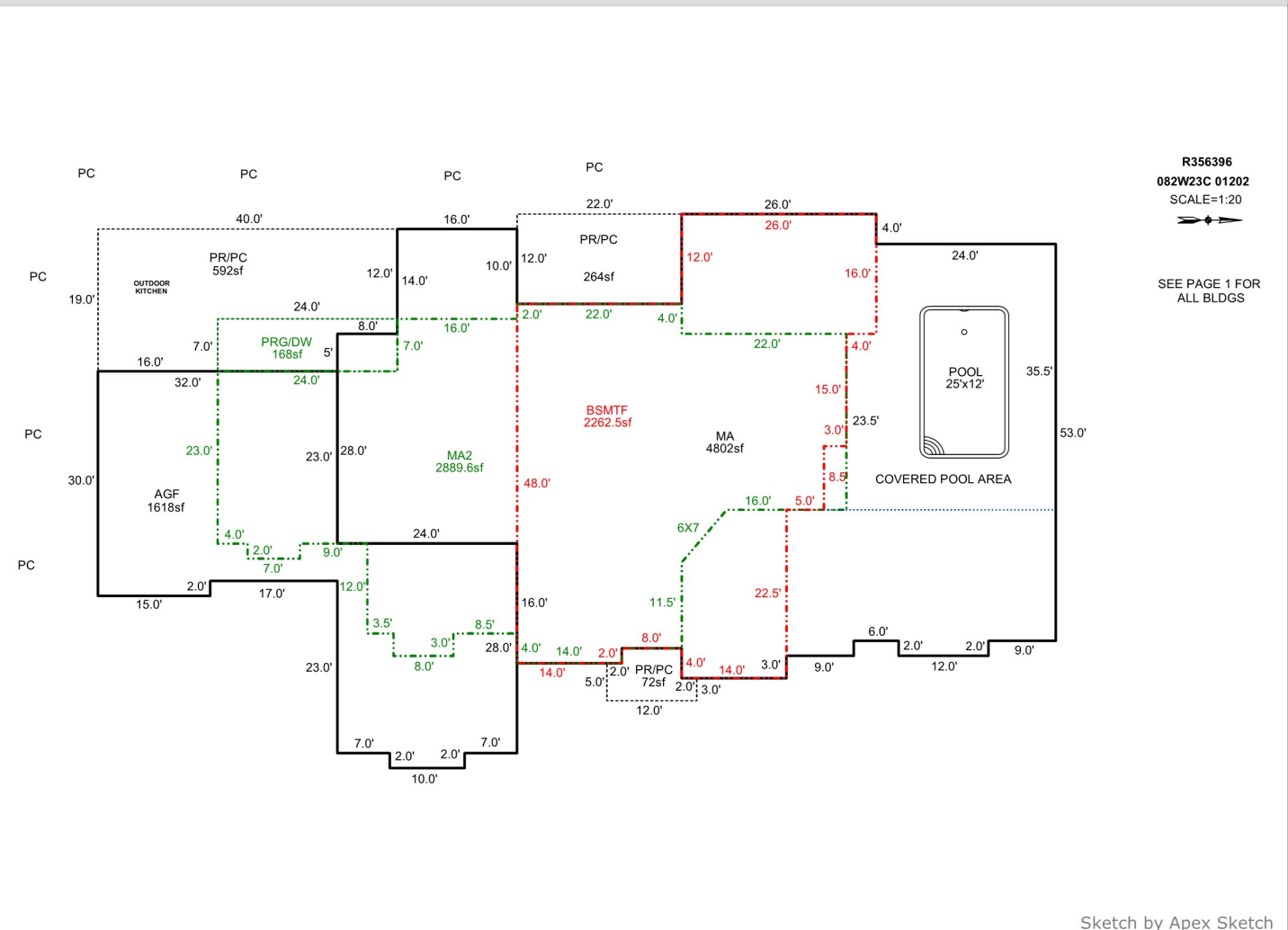

AREA CALCULATIONS SUMMARY

Code	Description	Factor	Net Size	Perimeter	Net Totals
GLA1	MA	1.0	4802.0	344.0	4802.0
GLA2	MA2	1.0	2889.6	270.3	2889.6
BSMT	BSMTF	1.0	2262.5	224.0	2262.5
GAR	AGF	1.0	1618.0	222.0	1618.0
P/P	PR/PC	1.0	592.0	118.0	
	PR/PC	1.0	264.0	68.0	
	PR/PC	1.0	72.0	38.0	
	PRG/DW	1.0	168.0	62.0	1096.0
Net LIVABLE		cnt	2 (rounded)		7,692

COMMENT TABLE 1

APEX BY CJURAN 05/25/2021 555-21-001992 & 555-21-002162
 UPDATED BY CJURAN 06/28/2021 555-21-003500
 UPDATED BY CJURAN 01/24/2022
 UPDATED BY CJURAN 01/11/2023 555-22-010959

COMMENT TABLE 2

COMMENT TABLE 3



356396 MA Front
2021-12-07 L2



R356396 DGOF-LTE- (2)
2021-09-24 L2



R356396 DGOF-LTE- (5)
2021-09-24 L2



R356396 DGOF-LTE- (8)
2021-09-24 L2



R356396 DGOF-LTE- (1)
2021-09-24 L2



R356396 DGOF-LTE- (4)
2021-09-24 L2



R356396 DGOF-LTE- (7)
2021-09-24 L2



R356396 Rear Patio- (2)
2021-09-24 L2



R356396 DGOF-LTE- (3)
2021-09-24 L2



R356396 DGOF-LTE- (6)
2021-09-24 L2



R356396 DGOF-LTE- (11)
2021-09-24 L2



R356396 MA Front- (3)
2021-09-24 L2



R356396 MA N End- (2)
2021-09-24 L2



R356396 DGOF-LTE- (10)
2021-09-24 L2



R356396 MA Front- (2)
2021-09-24 L2



R356396 MA N End- (1)
2021-09-24 L2



R356396 DGOF-LTE- (9)
2021-09-24 L2



R356396 MA Front- (1)
2021-09-24 L2



R356396 MA Front- (4)
2021-09-24 L2



R356396 MA Rear- (3)
2021-09-24 L2



R356396 MA Rear- (6)
2021-09-24 L2



R356396 MA Rear- (9)
2021-09-24 L2



R356396 MA Rear- (2)
2021-09-24 L2



R356396 MA Rear- (5)
2021-09-24 L2



R356396 MA Rear- (8)
2021-09-24 L2



R356396 MA Rear- (1)
2021-09-24 L2



R356396 MA Rear- (4)
2021-09-24 L2



R356396 MA Rear- (7)
2021-09-24 L2



R356396 MA S End- (2)
2021-09-24 L2



R356396 MA-BSMT- (3)
2021-09-24 L2



R356396 MA-SP- (3)
2021-09-24 L2



R356396 MA S End- (1)
2021-09-24 L2



R356396 MA-BSMT- (2)
2021-09-24 L2



R356396 MA-SP- (2)
2021-09-24 L2



R356396 MA Rear- (10)
2021-09-24 L2



R356396 MA-BSMT- (1)
2021-09-24 L2



R356396 MA-SP- (1)
2021-09-24 L2



R356396 Rear Patio- (1)
2021-09-24 L2



R356396 MA-SP- (4)
2021-09-24 L2