

Acct ID: 349471 MTL: 082W04A002702 Date: **08/28/23** Appr: **GRH** Prop Class: 401 RMV Prop Class: 401
 Situs: 1652 WHISPERING WAY SE SALEM OR 97317 **9/13/23** MaSaNh: 04 06 000 Unit: 79718 Year: **2023**
Last Date Appraised: 01/06/2023 Appraiser: GERARDO RAMIREZ Retag: **Y** Tag info: 2024 - Tags/Permit (Completion) **2024**
 HERNANDEZ **DN**
DFG - FINALED 03/20/23, MA C OF O 07/12/23
 Owner: MICHAEL & KATTY TSE JRT Roll Type: R
 Cycle **Tag** Sales Verification Other: _____ Inspection level: 1 2 **3** 4 LCB TTO INSP AV: 1109910
 RMV Land: 202450 RMV Imp: 954440 RMV Total: 1156890 MAV: 125470 MSAV: 0 SAV: 0
 Comment: 23-24: L2 01.06.23 MLH//1/4/22 L3 MHamilton
 LEVEL 4 C19 4-27-20 06WV

MA AND DGF @ 100% COMPLETED

INPUT GRH 03.04.24

Notations

No notation data available.

OSDs

Good. m/m

Count	Code	Description	RMV	Code Area	Exception
1	MKTN	OSD - NO LANDSCAPE	30000	92410	30000

Land

Site: 1 Code Area: 92410 Size: 2.00 Acres Use Code: 004 Zone: NREST SAV Use: Exception: 0
 Class: 2BD Value Source: Rural at MKT Description: TWO BENCH DRY RMV: 172450 Exception: Y N
 Adjustment(s): GSOIL Fire Patrol: Description:
 Comments: 21-22: #06 CYCLE C19, NO CHG //16-17: #29 CYCLE WORK, NO CHG / 10-11: COMBINED LAND SEG// 02400210

Improvements - Residence / Manufactured Structures

Bldg: 1 Code Area: 92410 Stat Class: 152 + Year Blt: 2022 Eff Year Blt: 2022 Sq.Ft: 3237 % Complete: **85**
 Desc: Multi Story above grade Dimensions: RMV: 697540
 Func Obsc: 100 Econ %: 100 Other %: 100 Exception: 697540 Adjust: Adjust RMV: 0
100% M/M

Floors

Type	Class	Display Group	Floor Size	Beds	Baths	Yr Blt	Eff Yr Blt	Inventory	Exception
First Floor	5 +	Finished	3237	3	FB-2/ HB-1	2022	2022	BATH - 2, BTH - 1, KIT, HVAC, FP <i>Kitchen +</i>	Exception: Y N
Attic	5 +	Unfinished	566	0	0	2022	2022		Exception: Y N
Garage Attached	5 +	Finished	946	0	0	2022	2022	ROOF	Exception: Y N

Accessories

Description	Class	Size SqFt	Eff Yr Blt	RMV	Quantity	Exception
YARD IMPROVEMENTS AVERAGE	5	0	2022	29580	1	Exception: Y N

Bldg: 2 Code Area: 92410 Stat Class: 148 Year Blt: 2022 Eff Year Blt: 2022 Sq.Ft: 2611 % Complete: **65**
 Desc: Res other improvements Dimensions: RMV: 256900
 Func Obsc: 100 Econ %: 100 Other %: 100 Exception: 256900 Adjust: Adjust RMV: 0
100% M/M

Floors

detached oversized garage, Attic Finished. Corrected for 2022

Type	Class	Display Group	Floor Size	Beds	Baths	Yr Blt	Eff Yr Blt	Inventory	Exception
First Floor	4	Finished	1562	0	0	2022	2022	ROOF	Exception: Y N
Second Floor	4	Finished	1049	0	FB-1	2022	2022	BATH - 1	Exception: Y N

Accessories

Description	Class	Size SqFt	Eff Yr Blt	RMV	Quantity	Exception
No accessory data available						

Improvements - Accessory Buildings

No improvement data available for all other stat class types.

SKETCH/AREA TABLE ADDENDUM

SUBJECT INFO

File No.: 349471 Parcel No.: 082W04A 02702
 Property Address: 1652 WHISPERING WAY SE
 City: SALEM County: MARION State: OR ZipCode: 97317
 Owner:
 Client: Client Address:
 Appraiser Name: Inspection Date:

SKETCH

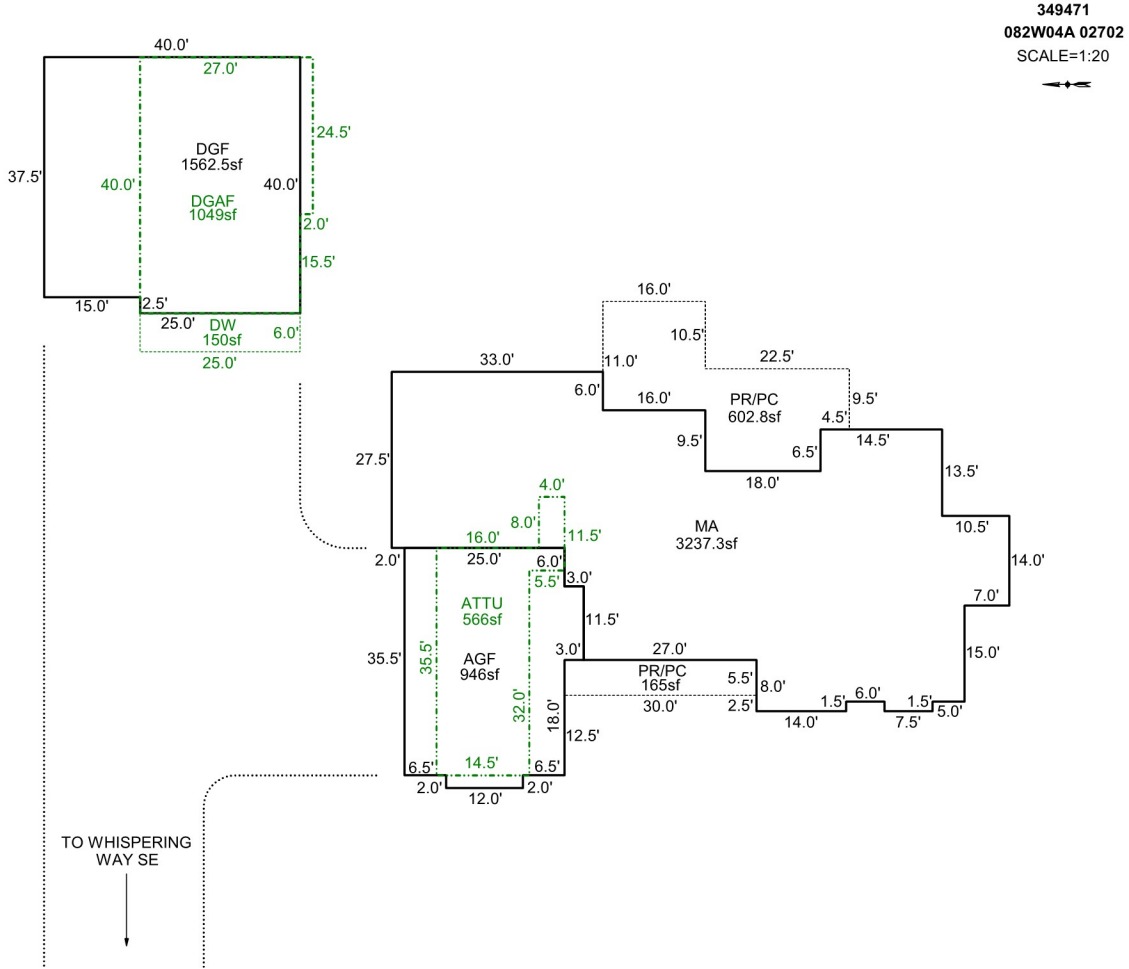

Sketch by Apex Sketch

AREA CALCULATIONS SUMMARY

Code	Description	Factor	Net Size	Perimeter	Net Totals
GLA1	MA	1.0	3237.3	315.0	3237.3
GLA2	ATTU	1.0	566.0	127.0	566.0
GAR	DGF	1.0	1562.5	160.0	
	DGAF	1.0	1049.0	134.0	
	AGF	1.0	946.0	131.0	3557.5
P/P	DW	1.0	150.0	62.0	
	PR/PC	1.0	602.8	130.0	
	PR/PC	1.0	165.0	71.0	917.8

COMMENT TABLE 1

APEX BY CJURAN 09/28/2021 555-21-009400
 & 555-21-010723
 UPDATED BY CJURAN 03/13/2023

COMMENT TABLE 2

MLH 01/06/2023
GRH 9/13/23

COMMENT TABLE 3

TAGS L2
TAGS L2

Net LIVABLE cnt 2 (rounded) 3,803



MA MA2 09.13.23



AGF MA MA2 09.13.23



DGOF DGAF 09.13.23



REAR DGOF DGAF 09.13.23